

Construction Plan No.1

Short Backstop Design (Design by Doug Tellier 676 Air cadets)

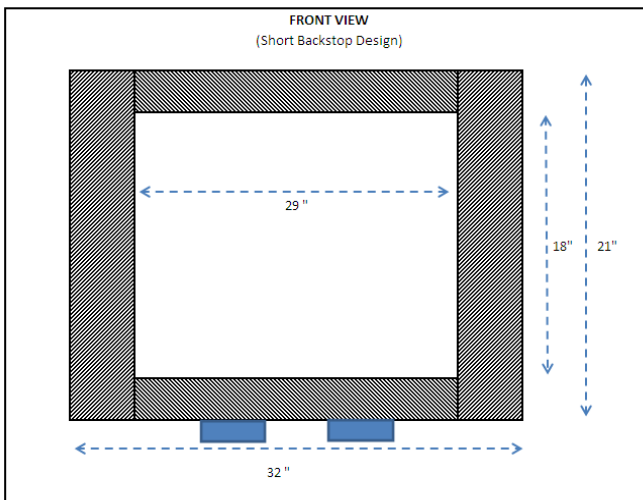
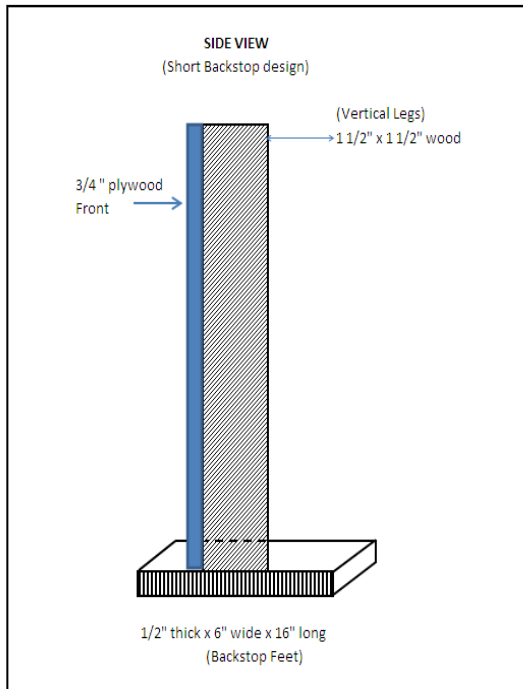

Note: You also need strong thick carpet that will fit into the inside frame this is so that the pellets will not hit the plywood directly or they will eventually go through the plywood. A front corrugated plastic is cut to cover the front end of the boards this can be bought at Industrial paint and plastic.

The layers should be installed as follow: Target → Plastic → Carpet → Plywood